



CAD DIMENSIONS Inc.

Your Partner in Design Solutions

MY.SOLIDWORKS.COM PROFESSIONAL ACCOUNT

DS SOLIDWORKS | Premium Cancel X

2020

DS DASSAULT SYSTEMES

Image courtesy of the Center for Advanced Design (CAD)

**AUTHORIZED
Reseller**

DS SOLIDWORKS

CONTENTS

SOLIDWORKS ONLINE ACCOUNT	4
How to Create a SOLIDWORKS Online Account.....	4
CREATE YOUR SOLIDWORKS ONLINE ACCOUNT.....	4
Log In to the Customer Portal Account & Register Your Product.....	7
REGISTER YOUR PRODUCTS	7

CADIMENSIONS TECHNICAL SUPPORT

My.SOLIDWORKS.com Professional

Congratulations on joining the My.SOLIDWORKS.com Professional Community. You will have access to numerous resources and learning tools. Once you have received your My.SOLIDWORKS Professional serial number, you will need to register that number in your Customer Portal. If you do not have a Customer Portal account, please follow the instructions in this document. You will need your SOLIDWORKS serial number to create your Customer Portal account. Then follow the instructions on how to register my product using the My.SOLIDWORKS Professional serial number provided. Once you have registered your product, you can now access the added features of My.SOLIDWORKS Professional.

If you have any questions, please call us at one of our offices below, or you can **create a technical support case** on our website, www.cadimensions.com. Thanks, and enjoy your trial!

Syracuse, New York

6310 Fly Road
East Syracuse, NY 13057
P: 315-434-9787

Rochester, New York

245 Summit Point Drive, Suite 4
Henrietta, NY 14467
P: 585-486-4740

Albany, New York

14 Computer Drive East
Albany, NY 12205
P: 518-438-0647

Buffalo, New York

180 Lawrence Bell Drive, Suite 104
Williamsville, NY 14221
P: 716-580-3498

Pittsburgh, Pennsylvania

2591 Wexford Bayne Road, Suite 203
Sewickley, PA 15143
P: 724-719-6045

Middletown, CT

203 Main Street, 300 Middlesex Plaza
Middletown, CT 06457
P: 860-704-6190

Philadelphia, PA

80 Lancaster Avenue, Suite 150
Devon, PA 19333
P: 484-367-7034

SOLIDWORKS ONLINE ACCOUNT

How to Create a SOLIDWORKS Online Account

Connect easily and quickly to a wide range of SOLIDWORKS resources and content through one SOLIDWORKS Online Account. Use this SOLIDWORKS ID to access your Customer Portal, My.SOLIDWORKS, and Forum accounts. Once you are logged in on one website, simply choose **Log In** to automatically sign in on the other websites.

CREATE YOUR SOLIDWORKS ONLINE ACCOUNT

1. Go to the **Customer Portal, My.SOLIDWORKS, or Forums** website.
2. Select **Log In**.
3. Select **Create a SOLIDWORKS ID**.



One Account | All SOLIDWORKS

A SOLIDWORKS ID gives you access to a wide range of resources and content.

Email:

Password:

Remember Me



[Forgot your password?](#)

[Create a SOLIDWORKS ID](#)

[Learn about the benefits of joining](#)

©2017 Dassault Systèmes SolidWorks Corp.

4. Enter your email address. Select the radio button for **I am a SOLIDWORKS customer with a SOLIDWORKS Serial #**. Enter your serial number (16 – 24 digits, no spaces) and click **Next**.

Create a SolidWorks Online Account

Email and Account Type > Company > Profile > Done

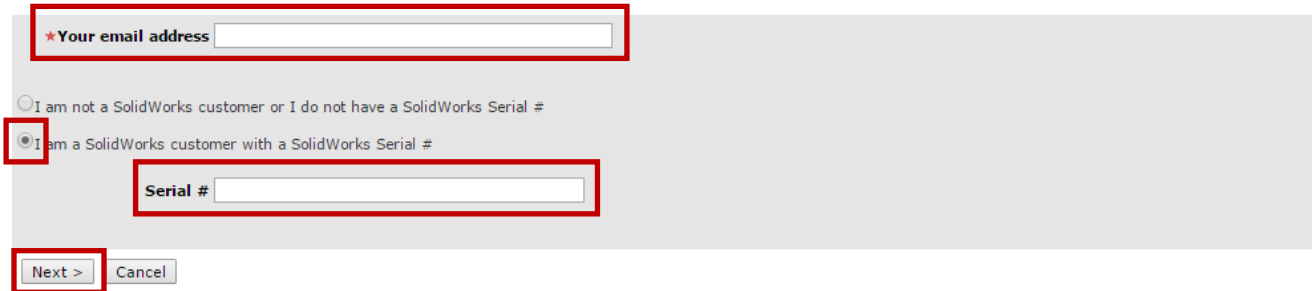

*Your email address

I am not a SolidWorks customer or I do not have a SolidWorks Serial #

I am a SolidWorks customer with a SolidWorks Serial #

Serial #

Note: Use the navigation buttons on these pages. **Do not use** your standard browser navigation buttons. To register or add additional products to your account, see **Register My Products** in the **Solidworks Customer Portal**.

5. Verify company account information. Click **Yes** if the information is correct, otherwise click **No** and correct the information.

Note: Only choose No if the company information is completely wrong. Selecting No will increase the amount of time it takes to create your account.

Create a SolidWorks Online Account

Email and Account Type > **Company** > Profile > Done

According to our records, this is your account information:

Account Name: CADimensions
Address1: 6310 Fly Rd
Address2:
City: East Syracuse
State/Province: NY
Postal Code: 13057-9325
Country: USA

Is your company information accurate?

Note: Use the navigation buttons on these pages. **Do not use** your standard browser navigation buttons.

- Complete the profile information and read the Export Eligibility Requirements. Then click **Next**.

Create a SolidWorks Online Account

Email and Account Type > Company > **Profile** > Done

★Required

★First Name:

★Last Name:

Email Address:

★Password:

★Re-Type Password:

Do not send SolidWorks Express

Do not send info on user groups, webinars and events

Do not send postal mail

Do not call me

Export Eligibility Requirements. Please confirm:

I am not a citizen, national or resident of, and am not under the control of, the government of any country to which the United States has prohibited export of technical information, such as (as of 12/30/09): Cuba, Iran, North Korea, Sudan, Syria.

I will not download or otherwise export or re-export the software, directly or indirectly, to the above-prohibited countries nor to citizens, national or residents of those countries.

I am not listed on the United States Department of Treasury list of Specially Designated Nationals, Specially Designated Terrorists, and Specially Designated Narcotics Traffickers, nor am I listed on the United States Department of Commerce Table of Denial Orders.

I will not download or otherwise export or re-export the software, directly or indirectly, to persons on the above-mentioned lists.

I will not use the software for, and will not allow the software to be used for, any purposes prohibited by United States law, including, without limitation, for the development, design, manufacture or production of nuclear, chemical, or biological weapons of mass destruction.

I confirm the accuracy of the statements above.

By Providing your information and continuing, you are confirming the accuracy of the Export Eligibility Requirements and agree to the Terms of use and Privacy Policy.

Note: Use the navigation buttons on these pages. **Do not use** your standard browser navigation buttons.

- Account has been created. Check for confirmation email.

Create a SolidWorks Online Account

Email and Account Type > Company > Profile > **Done**

Thank you for registering with the SolidWorks community.

You will be receiving a confirmation email shortly.
Click on the link in the email to activate your account.

Please ensure you add the "solidworks.com" domain to your allowed senders list to ensure receipt of email messages.

You can now close this window.

- Go to the **Customer Portal** and sign in using the email address and password you chose.

Log In to the Customer Portal Account & Register Your Product

Anyone can create a free SOLIDWORKS Online Account, however to enable full access to all of the features you need to register a serial number with an active subscription service contract through the **Customer Portal**.

Customer Portal Features

- ★ Download the latest SOLIDWORKS software versions and service pack updates.
- ★ View your SRs (Service Requests).
- ★ View your SPRs (Bugs).
- ★ Make Enhancement Requests.
- ★ Review Subscription Service Renewal Information
- ★ Review and register your software licenses
- ★ Edit your profile.

My.SOLIDWORKS

- ★ Access SOLIDWORKS online learning content based on training courses offered by VARs.
- ★ Online training manuals for customers who attend a VAR training session
- ★ Access and Search the Knowledge Base Solutions, SPRs (bugs), and online help
- ★ Search and get the best answer to your question from across the SOLIDWORKS community
- ★ Browse and Stay up to date with Current SOLIDWORKS blog posts, videos, forum posts, and more.
- ★ Bookmark items you find useful to quickly and easily get back to them
- ★ Access the Knowledge Base, containing a wide range of technical documents and resources.

Forums

- ★ Access more than 120,000 SOLIDWORKS users for tips, advice, and best practices.

REGISTER YOUR PRODUCTS

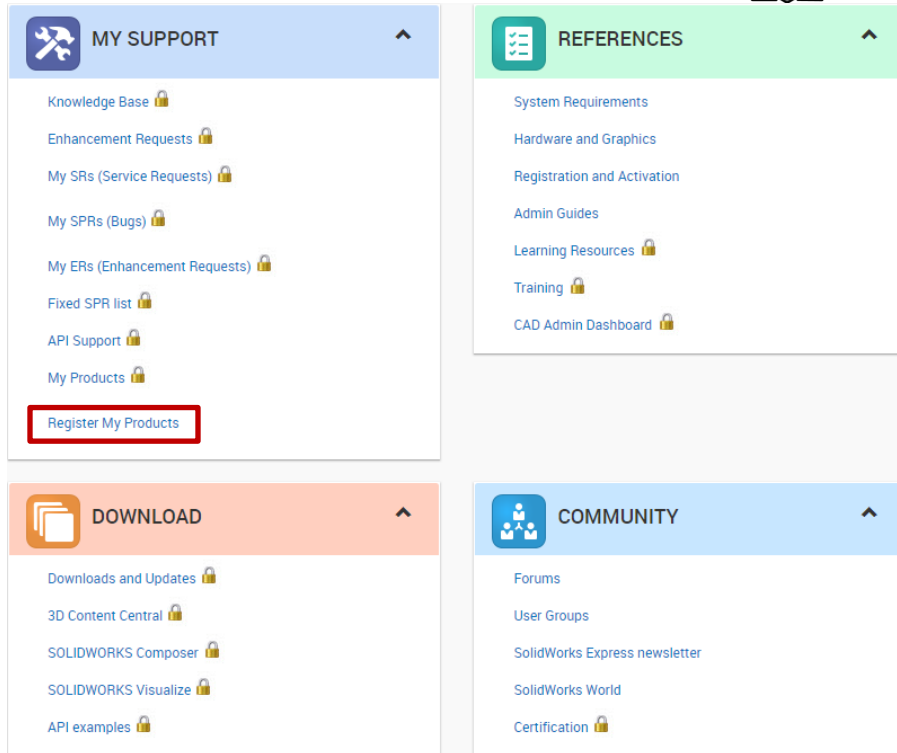

1. From the Customer Portal, select **Register My Products**.

Note: You will see padlocks next to the features in the customer portal which are only available to active subscription customers.

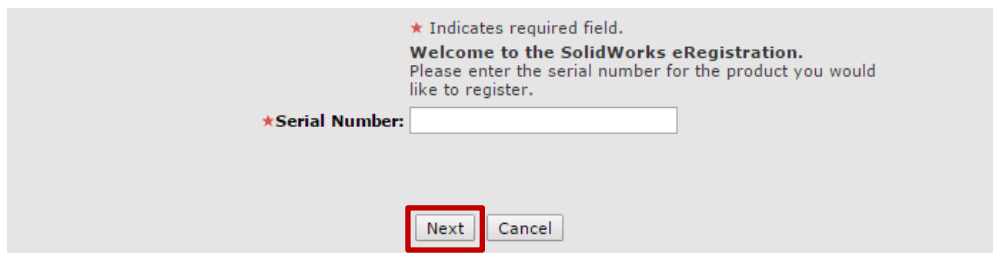

2. Enter active Serial Number, then click **Next**.



3. Select the version you would like to register by clicking the  next to the blank then select the version by clicking the , then click **Next**.

Note: Always choose the latest version available.

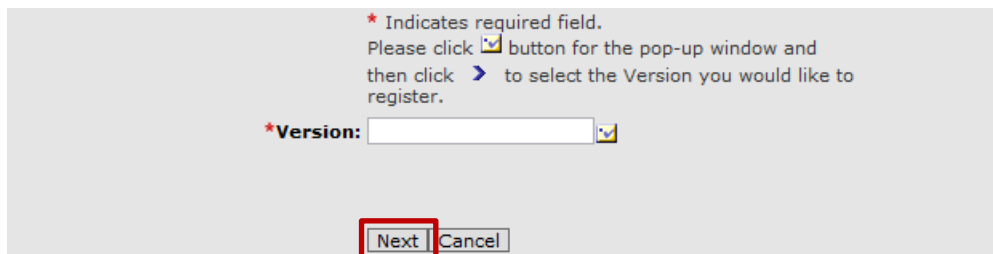

4. You should now have full access to the SolidWorks Customer Portal features. If you see padlocks next to the features in the customer portal, either your maintenance has expired, or there was an issue with registering your software. Please contact Support.

NEED ADDITIONAL SUPPORT?

If you have an existing case, please contact the Application Engineer you are working with; otherwise **submit a new case online** or see our **local office listing** for additional contact information.